

INSTRUCTIONS

AIR HOGS™ DOMINATOR™



Experience radio-controlled (R/C) flight micro-sized with the AIR HOGS™ R/C Dominator™! The Dominator™ makes flying easy! Just choose the direction you want to fly, and press the controller toggle. The Dominator™ has full-function radio control so you can control up, down, left or right. The Dominator™ is powered by 2 motors and is made of damage-resistant, high-density foam. The Dominator™ also features an integrated charger-controller unit for convenient portability and easy handling on the field. **Take flight and master the skies!**

PLEASE REFER TO INSTRUCTIONS BEFORE FLYING.

Check to make sure contents are complete:

1 Dominator™ 1 Instruction Manual
1 Charger-Controller

BATTERY INSTALLATION

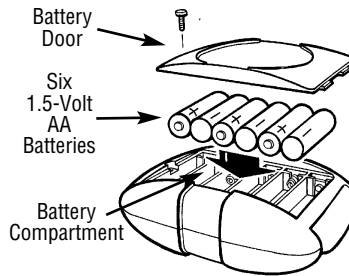
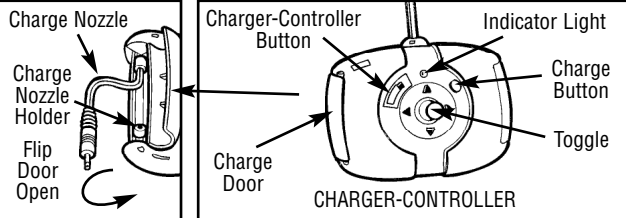

1. Use a Phillips screwdriver to unscrew and remove the battery door.
2. Install **six 1.5-Volt AA alkaline batteries (not included)**. Be careful to align the positive (+) and negative (-) polarities with the corresponding markings inside the battery compartment.
3. Reinstall the battery door and tighten the screw.

CHARGING

Charge the plane's internal batteries for 4 minutes. Note: If you notice your flight time decreasing over time, you may increase the charge time up to 8 minutes for better performance. Never charge more than 8 minutes or you may burn out the batteries.

<p>1 Push the plane's ON/OFF switch backwards to set the plane to OFF.</p>	<p>2 Set the Charger-Controller to CHARGER ON.</p>	<p>3 Flip the Charge Door open to reveal the Charge Nozzle.</p>	<p>4 Push Charge Nozzle into the Plane's Charge Port, located in the bottom of the airplane.</p>	<p>5 Press the Charge Button to start charging. During charging, the Indicator Light will Blink Red. The charge cycle will be completed in 2 minutes.</p>
<p>6 If the Dominator™ disconnects (falls off) the Charge Nozzle during charging, put it back onto the Charge Nozzle and re-press the Charge Button to restart charging.</p>	<p>7 When charging is complete, the Indicator Light will turn GREEN.</p>	<p>8 DOUBLE-CHARGE the plane on your FIRST FLIGHT of the day (total 8 minute charge). For all OTHER FLIGHTS, CHARGE ONLY ONCE.</p>	<p>9 Remove Dominator™ gently from the Charge Nozzle.</p>	<p>10 Place Charge Nozzle into the Charge Nozzle Holder and close the Charge Door.</p>

Because the Dominator's AA batteries are used for 2 functions, charging and controlling, they will need to be replaced after every 20 flights.

CHARGING TIPS (OPTIONAL STEPS)

<p>Bottom of controller Docking Area</p> <p>Bottom of plane Docking Pegs</p>	<p>Align the plane's DOCKING PEGS with the controller's DOCKING AREA.</p> <p>4. i) Insert the plane's DOCKING PEGS into the DOCKING AREA circles.</p> <p>ii) Slide the plane down the controller carefully.</p>	<p>4. iii) Turn the charger on, following steps CHARGING 5.</p> <p>iv) Either hold or place the plane and controller on a safe and stable surface while charging.</p>	<p>4. v) Carefully remove the plane from the charger, by sliding the plane's DOCKING PEGS up on the controller and pulling the DOCKING AREA circles.</p>
--	--	---	---

PRE-FLIGHT ENVIRONMENT CHECK

1. **Location** – Fly in a large, wide-open, grassy location that is free of buildings, trees, overhead wires, and other obstructions. Do not fly near people or animals.
2. **Weather** – Fly on mild, sunny days. Do not fly in electrical storms, rain, sleet, snow, or other adverse weather conditions. Do not fly if the temperature is below 45°F/7°C. In very cold temperatures, the plane will become fragile and the engine performance will decrease.
3. **Wind Conditions** – Do not fly in wind. Winds may overpower the plane and make it difficult to control. In windy conditions, it may appear as though you have no control over the plane.

FLYING INSTRUCTIONS

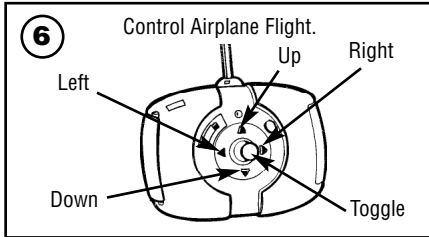
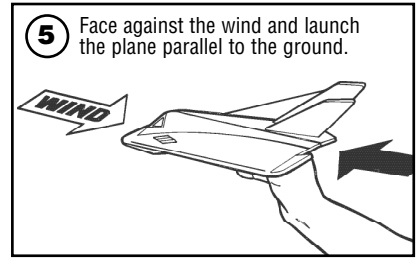
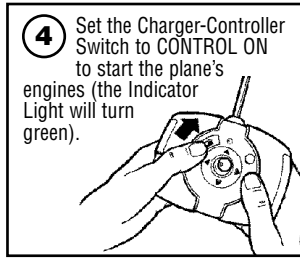
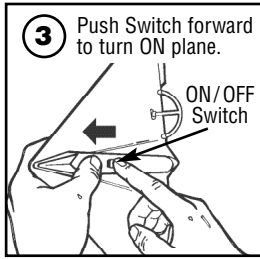
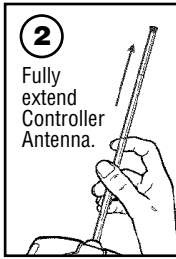
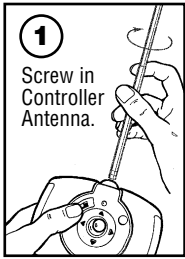

7 To land, select a soft grassy area, and press the toggle DOWN.

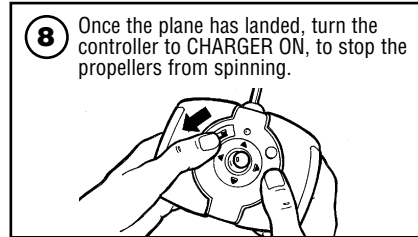

AUTOMATIC SHUT OFF

To preserve battery power, your Dominator's controller-charger will automatically shut off after 15 minutes without use. To re-activate it, simply move the toggle or press the "CHARGE" button.

TROUBLE SHOOTING GUIDE

PROBLEM	CAUSE	SOLUTION
Plane will not start or has low power.	<ol style="list-style-type: none"> 1. Plane not charged. 2. Battery power is drained. 3. Plane was not set to OFF during charging. 4. Charger-controller was not set to CHARGER ON. 	<ol style="list-style-type: none"> 1. Charge plane for 4-8 minutes (see Charging). 2. You will need to replace the charger-controller's batteries after 20 flights. 3. The plane will not accept a charge in the ON position. Always set to OFF before charging. 4. The charger-controller will NOT charge in the CONTROL ON position. Always set the charger-controller to CHARGER ON before attempting to charge.
Plane will not turn.	<ol style="list-style-type: none"> 1. Controller is not set to CONTROL ON. 2. Controller antenna is not extended. 3. It is a windy day. 4. Airplane antenna not uncoiled. 	<ol style="list-style-type: none"> 1. Set controller to CONTROL ON. 2. Fully extend Controller antenna before flying. 3. Do not fly in winds. Windy conditions will limit and may prevent your ability to control the plane. 4. Uncoil airplane antenna.
Plane is flying too low.	<ol style="list-style-type: none"> 1. Needs more power. 2. The 6 AA batteries in the Charger-Controller are drained. 	<ol style="list-style-type: none"> 1. Press the toggle UP. 2. Install new batteries.
Plane is flying too high.	<ol style="list-style-type: none"> 1. Need to decrease power. 	<ol style="list-style-type: none"> 1. Press the toggle DOWN.

QUESTIONS?

Email us at toys@spinmaster.com or call our friendly flight technicians toll free at 1-800-622-8339

BATTERIES

IMPORTANT BATTERY INFORMATION: • Battery installation should be performed by an adult. • Use only batteries recommended in this instruction manual. • Be careful to install the batteries with the correct polarity, as indicated. • Do not mix old and new batteries. • Do not mix alkaline, standard, rechargeable, or different types of batteries. • Different types of batteries or new and used batteries are not to be mixed. • Do not use rechargeable batteries. • Non-rechargeable batteries are not to be recharged. • Rechargeable batteries are to be removed from the toy before being charged (if removable). • Rechargeable batteries are only to be charged under adult supervision (if removable). • Only batteries of the same or equivalent type as recommended are to be used. • The supply terminals are not to be short-circuited. • Exhausted batteries are to be removed, as they will adversely affect the performance. Dominator™ takes six 1.5-Volt AA Batteries (not included). CAUTION: Do not dispose of battery in fire. Battery may explode or leak.

FCC REQUIREMENT

CAUTION: Changes or modifications to this product not expressly approved by the party responsible for compliance may void the user's authority to operate the equipment.

IMPORTANT SAFETY INFORMATION

Keep plane from face, eyes and hair at all times. Keep fingers away from the moving propellers. Do not launch plane near other people or animals. Use caution, make sure people around you know that you are playing with the DOMINATOR™. Recommended for use in large, wide-open, grassy areas. Do not fly near overhead wires, buildings, trees, or other obstructions. Be sure to fly on a clear sunny day. **Do not fly in WIND. Flying in wind will severely diminish your ability to control the airplane.** In some situations, where the wind is very strong, the wind may overpower the airplane and you will not be able to control it. Do not fly in adverse weather conditions such as electrical storms, rain, sleet or snow. Do not fly in temperatures below 45°F/7°C. Do not fly in temperatures above 113°F/45°C. For charging, use ONLY the charger provided in this package. Do not use any other source to charge the DOMINATOR™. Do not overcharge your airplane. Follow the charging instructions provided in the instruction manual contained within this package.

Spin Master Ltd., 450 Front Street West, Toronto, ON M5V 1B6 Canada
 Spin Master, Inc., PMB #10053, 300 International Drive, Suite 100, Williamsville, NY 14221
 Spin Master Toys Far East Limited, Rm # 1113, 11/F, Chinachem Golden Plaza,
 77 Mody Rd., Tsimshatsui E., Kowloon, HK
 Spin Master France SAS, 36 rue de Sully, 92100 Boulogne, France

North American Consumer Information
 Phone: 1-800-622-8339
www.spinmaster.com

Air Hogs TM and Dominator TM are trademarks of Spin Master Ltd.
 © 2004 Spin Master Ltd. All rights reserved.
 Manufactured for and distributed by Spin Master Ltd.
 Conforms to safety standards ASTM F963-03,
 EN71 Regulatory Requirements. Products and colors may vary.
 Please retain this information for future reference.
 MADE IN CHINA.

REV 5 US ENG – Timer/Hose Asst. #44053.

**Contains NiMH battery pack.
 Battery pack must be recycled
 or disposed
 of properly.**

